

Pluggable Terminal Blocks

CSF Plug

CSM Header

Specifications: **CSF/CSM Series**

Features:

- \*CSF is **green** color with clamp in the *open* position
- \*Double captive screws
- \*Elevator clamp system
- \*2 to 25 positions single mold
- \*Can also be side stackable
- \*Vertical or right angle orientations
- \*Housing is resistant to chlorinated solvents, with no dioxin or detrimental to health halogens.
- \*Every position of this product is mechanically and electrically tested during assembly to ensure a 100% defect free product.
- \*Minimum 5 microns of tin plating on terminal for easy soldering.

Electrical

Current:	10A @ 300V
Wire range:	16 to 30 AWG
Wire section(mm <sup>2</sup> ):	0.05 to 1.5mm <sup>2</sup>
Pin diameter:	φ1.3mm
CR:	<15 mΩ
IR:	>10 <sup>9</sup> Ω (500V DC)
Operating temp:	-40°C to 105°C
Stripping length:	5mm
Torque:	3.5 lb-in
PCB holes:	min 1.4mm
PCB thickness:	max 2.4mm
Climactic category:	40/110/21 Acc. to IEC 68-1
Insertion force:	max 2 N
Disconnecting force:	min 1.2 N

Materials

Housing:	Polyamide 6,6 (UL94V-0)
Clamp:	Copper alloy, Ni plated
Spring:	Phosphorus bronze, Tin plated
Screw:	M3, copper alloy, Ni plated
Pin (header):	Copper alloy, Tin plated
Colors available:	Green

Marking

Numbered marking strips 5mm centers.

Numbered	Order Number
1-10	ESA14000110
11-20	ESA14001120
21-30	ESA14002130
31-40	ESA14003140
41-50	ESA14004150

Ink marking by factory (specify in order number):

Factory ink is permanent and will not rub off. Ink has fluorescent tint for greater visibility.

0=no printing

A=upside down printing (consecutive #'s R to L)

B=regular printing (consecutive #'s L to R)

Custom markings are welcome with minimum order. Contact factory for information.

10A 300V

5mm

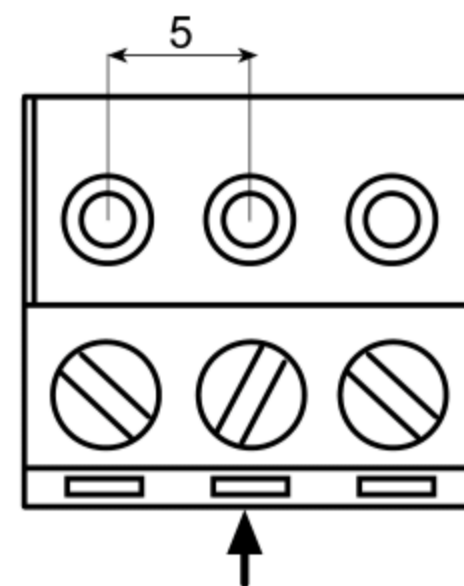
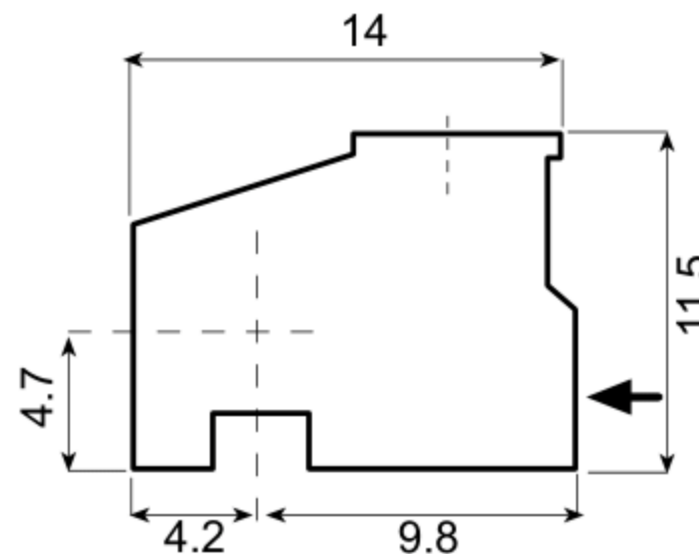
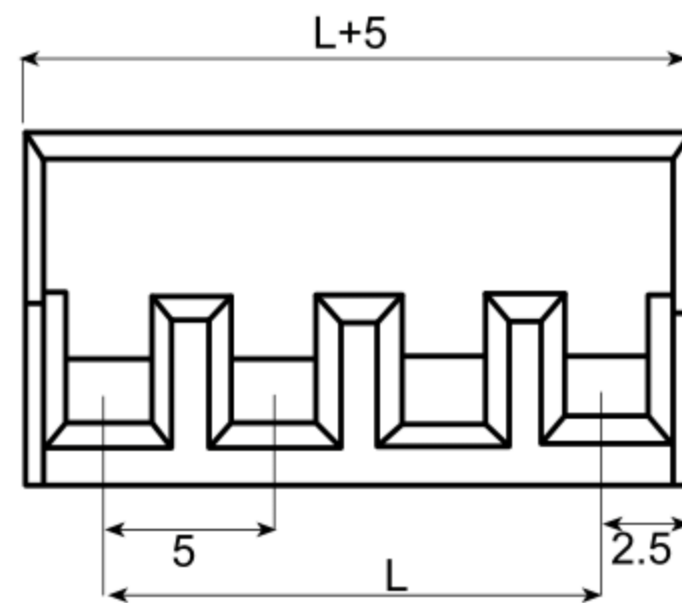
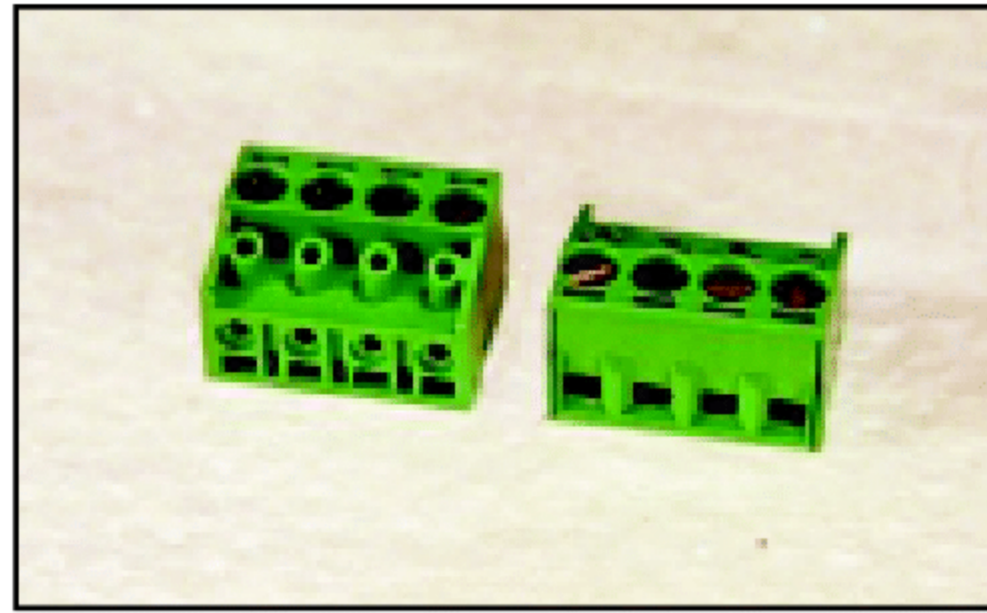

Elevator Clamp System

Dimensions

n=number of poles  
L=(n-1) x 5

Ordering Information

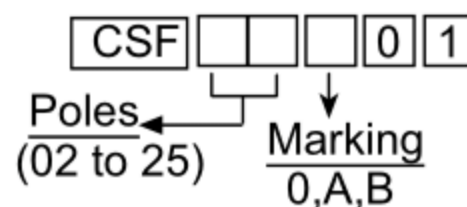

Also available in 10mm centers.

12A 300V

5mm

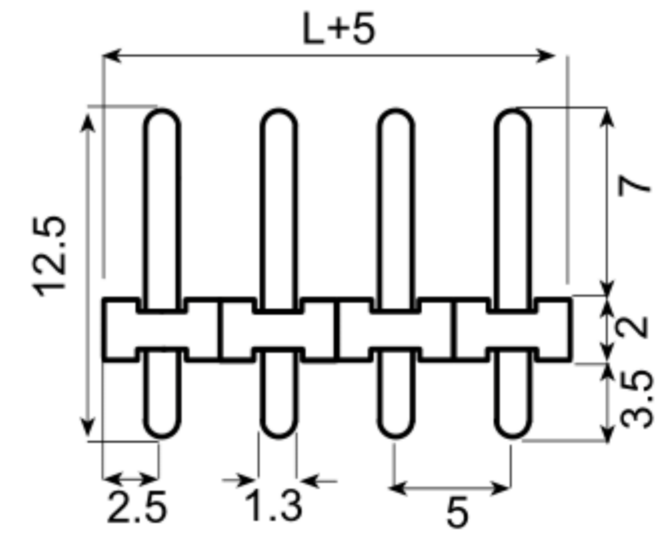
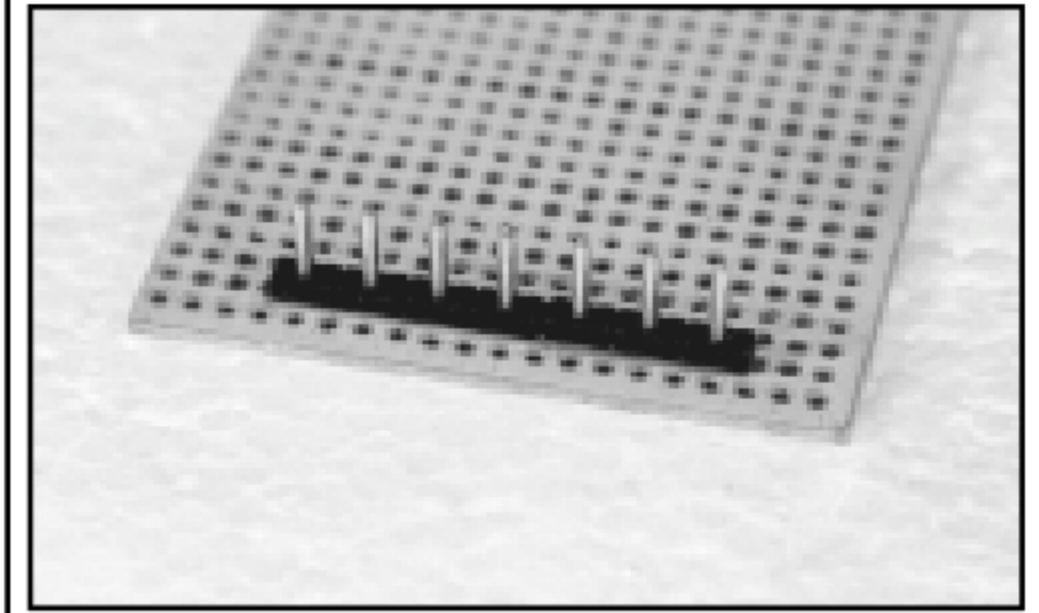

PCB Layout

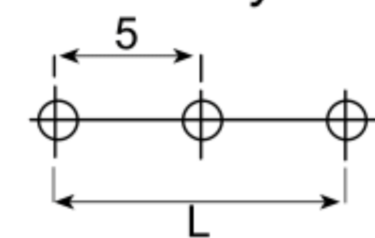

Dimensions

n=number of poles  
L=(n-1) x 5

Ordering Information



Also available in 10mm centers.