

Specifications: MTS Series

Features:

- Compact 3.5 or 3.81 spacing
- MTS is supplied with the clamp in the open position
- Double captive screws
- Elevator clamp system
- Testing points
- 2 to 25 positions single mold
- Housing is resistant to chlorinated solvents, with no dioxin or detrimental to health halogens
- Every position of this product is mechanically and electrically tested during assembly to ensure a 100% defect free product
- Minimum 5 microns of tin plating on terminal for easy soldering

Electrical

Current: 12A @ 300V
 Wire Range: 14-30 AWG
 Wire Section: (mm²) 0.05 to 1.3mm²
 Pin Dimension: 0.8mm x 0.4mm
 CR: <15mΩ

Operating temp: -40°C - +110°C
 Stripping Length: 5mm
 Torque: 0.13 Nm
 PCB Holes: min 1.1mm
 PCB Thickness: max 2.3mm
 Climatic Category: 40/110/21 Acc. To IEC 68-1

Materials

Housing: Polyamide 6,6 (UL 94V-O)
 Clamp: Copper Alloy, NI plated
 Terminal: Copper Alloy, Tin-plated
 Screw: M2, Copper Alloy, Ni plated
 Colors Available: Green and Black

Marking

Adhesive strips not available
Ink marking by factory (specify in order number):
 Factory ink is permanent and will not rub off.
 Ink has fluorescent tint for greater visibility
 0 = no printing
 A= upside down printing (consecutive #'s R to L)
 B= regular printing (consecutive #'s L to R)

12A 300V 3.5 and 3.81 mm

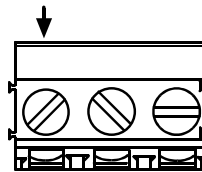
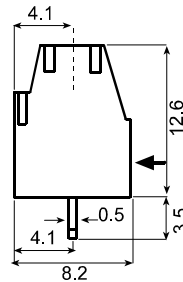
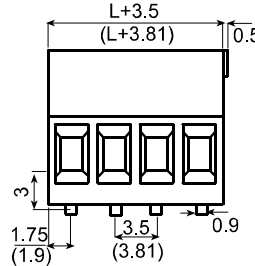
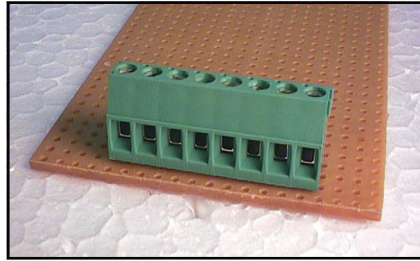

PCB Layout

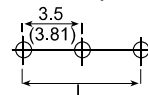

Dimensions

n = number of poles
 L=(n-1) x 3.5 (for 3.5mm spacing)
 L=(n-1) x 3.81 (for 3.81mm spacing)

Ordering Information

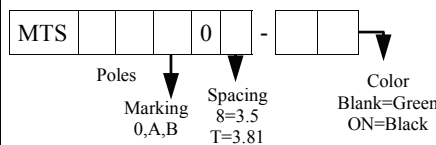

7A 250V 3.5 and 3.81 mm

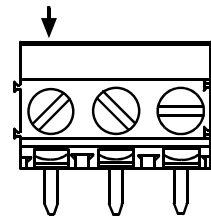
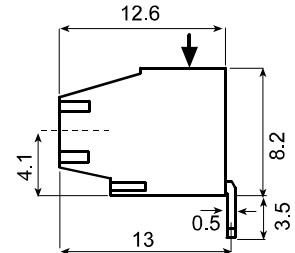
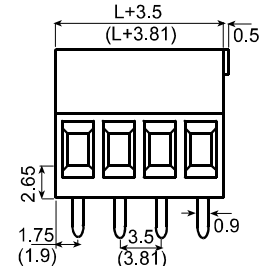
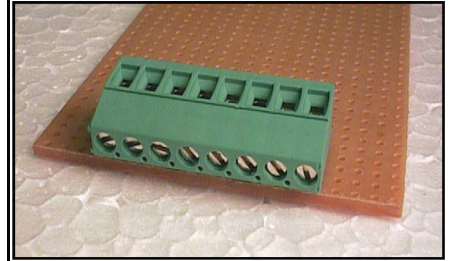

PCB Layout

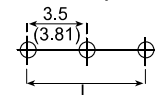

Dimensions

n = number of poles
 L=(n-1) x 3.5 (for 3.5mm spacing)
 L=(n-1) x 3.81 (for 3.81mm spacing)

Ordering Information

